









C:\Users\jym\OneDrive\Documents\10724 A STANDARD ES MODERNIZATION\_rjm.odm.rvt

LOT DATE: 10/11/2019 12:53:41 PM

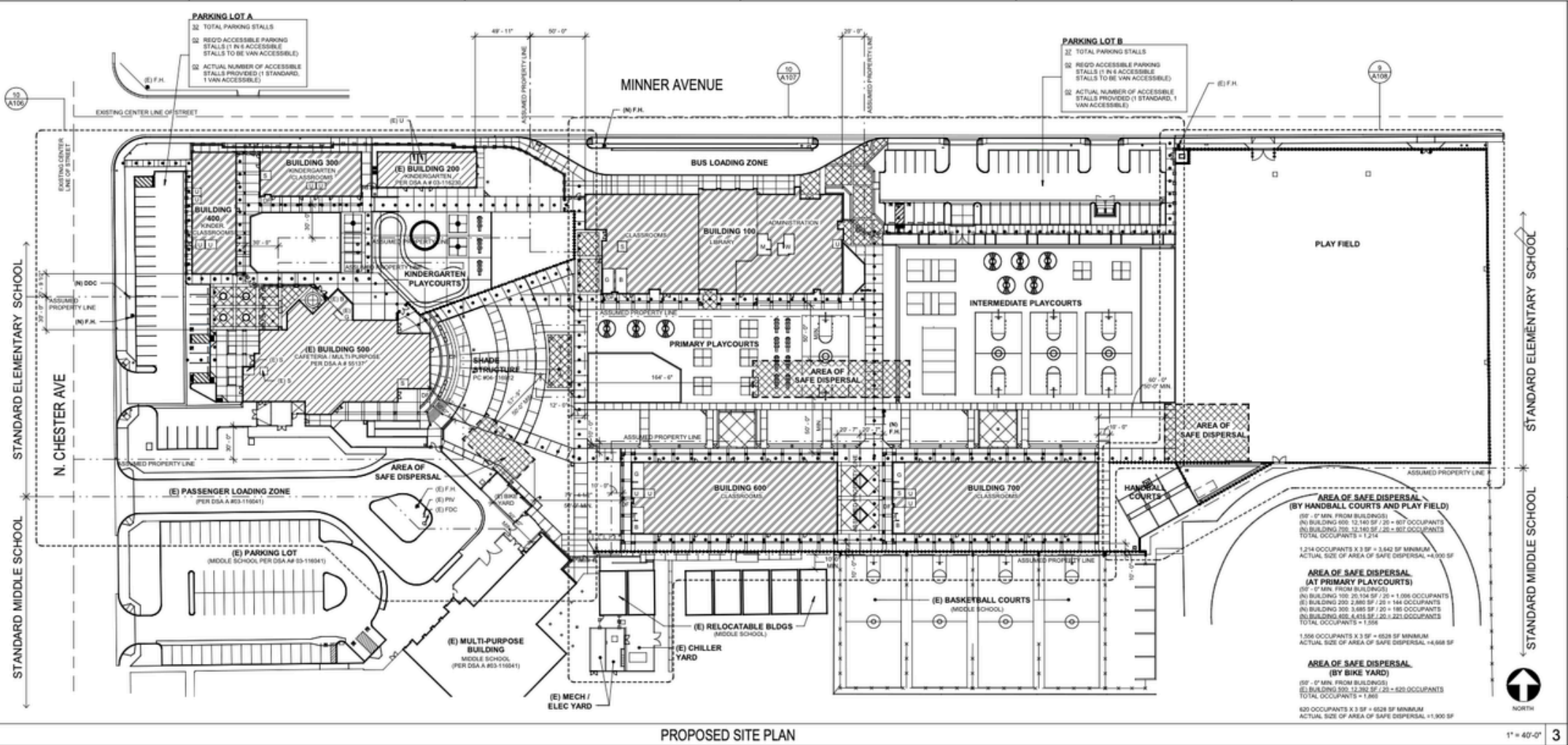

PROPOSED SITE PLAN

1" = 40'-0" 3



- GENERAL NOTES**
- A. REFER TO CIVIL, LANDSCAPE, PLUMBING, MECHANICAL AND ELECTRICAL DRAWINGS FOR ADDITIONAL INFORMATION.
  - B. ALL DIMENSIONS SHALL BE FIELD VERIFIED PRIOR TO CONSTRUCTION.
  - C. FOR ADDITIONAL BUILDING INFORMATION AND CODE ANALYSIS, SEE SHEET 0302.

QUALIFICATION STATEMENT OF THE STATE ARCHITECT  
 APP. 03-119797 INC.  
 REVIEWED FOR:  
 SS TO: FILED ACS 23  
 DATE: 10/22/2019

MARK	DATE	DESCRIPTION
N	10/17/19	DIS-BACK CHECK



**TETER, LLP**  
 FIRMING ARCHITECTS  
 10000 WILSON AVENUE, SUITE 100  
 ARCHITECTS ENGINEERS CONNECTED



MODERNIZATION  
 STANDARD ELEMENTARY SCHOOL  
 115 MINNER AVE  
 DUBLIN, CA 94568  
 OVERALL PROPOSED SITE PLAN

PROJECT NO.  
 17-10724  
 DRAWING  
**A104**